

K5500/5550 series Installation Dimensions & Tech Data

Length calculation

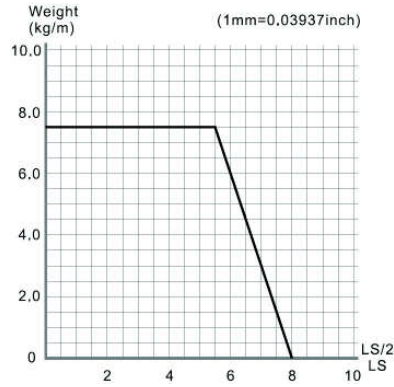
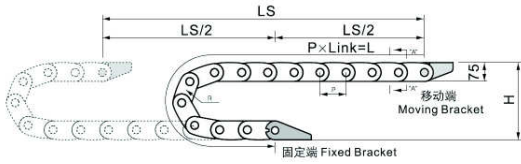

$$L = \frac{LS}{2} + \pi \times R + 364$$

L: Length
 R: bending Radius
 H: Installation Height
 P: Pitch
 364: Safety Length

K5500 series can be open by both side

Type	Inner width (mm)	Outer width (mm)	Bending radius(mm)	Pitch (mm)	Weight (kg)
5500.100.□.0	100	145	150 200 250 300 350	91	3.90
5500.125.□.0	125	170	150 200 250 300 350	91	4.20
5500.150.□.0	150	195	150 200 250 300 350	91	4.50
5500.175.□.0	175	220	150 200 250 300 350	91	4.60
5500.200.□.0	200	245	150 200 250 300 350	91	4.70
5500.250.□.0	250	295	150 200 250 300 350	91	4.80
5500.300.□.0	300	345	150 200 250 300 350	91	4.90
5500.350.□.0	350	395	150 200 250 300 350	91	5.20
5500.400.□.0	400	445	150 200 250 300 350	91	5.50

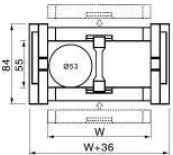

K5550 series can be open by both side

Type	Inner width (mm)	Outer width (mm)	Bending radius(mm)	Pitch (mm)	Weight (kg)
5550.100.□.0	100	145	150 200 250 300 350	91	4.50
5550.125.□.0	125	170	150 200 250 300 350	91	5.00
5550.150.□.0	150	195	150 200 250 300 350	91	5.40

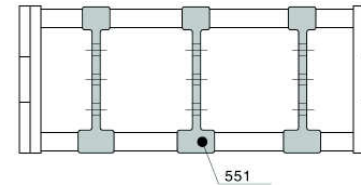
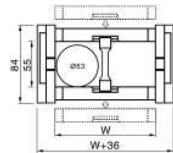

Fixed bracket

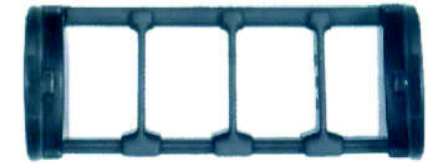
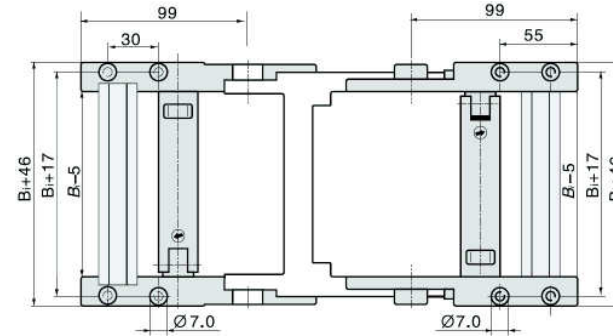

Moving bracket

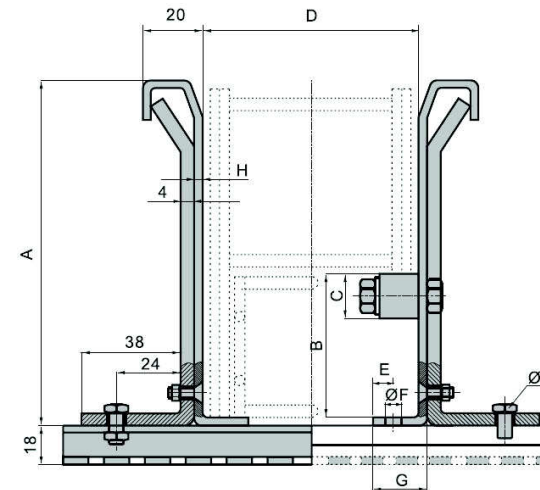
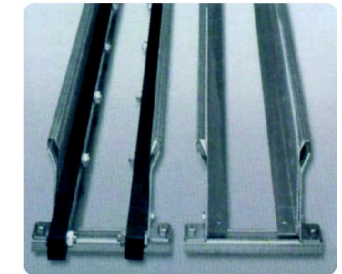
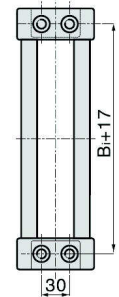

Cable tray without slide strip	1
Cable tray with slide strip	2
A	170
B	84
C	30
D	*
E	20
F	11
G	50
H	2

K6500/6550 series Installation Dimensions & Tech Data

Length calculation

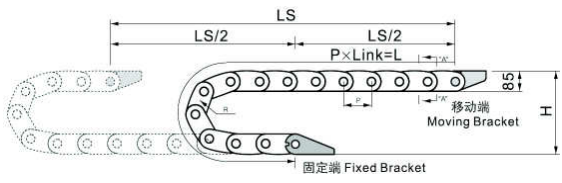

$$L = \frac{LS}{2} + \pi \times R + 364$$

L: Length
 R: bending Radius
 H: Installation Height
 P: Pitch
 364: Safety Length

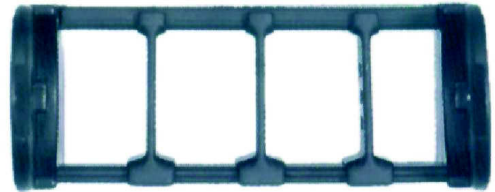
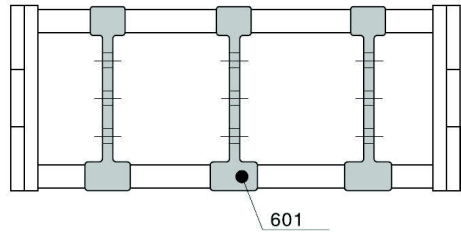
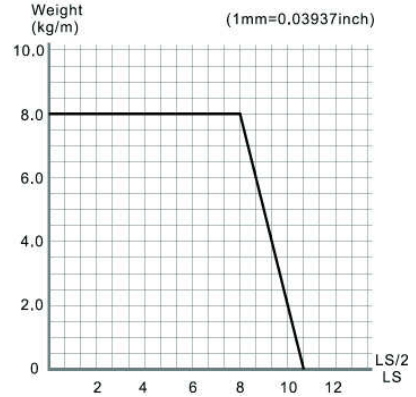

Fixed bracket

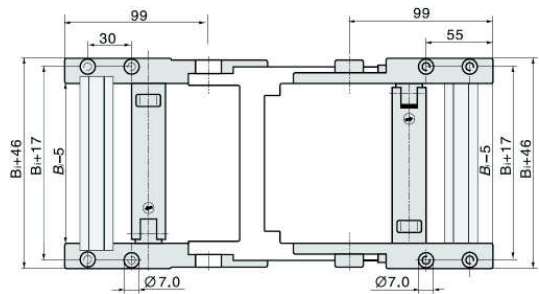

Moving bracket

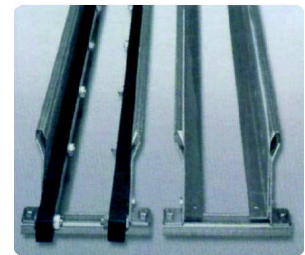

K6500 series can be open by both side

Type	Inner width (mm)	Outer width (mm)	Bending radius(mm)	Pitch (mm)	Weight (kg)
6500.100.□.0	100	152	150 200 250 300 350	91	4.30
6500.125.□.0	125	177	150 200 250 300 350	91	4.40
6500.150.□.0	150	202	150 200 250 300 350	91	4.50
6500.175.□.0	175	227	150 200 250 300 350	91	4.65
6500.200.□.0	200	252	150 200 250 300 350	91	4.80
6500.250.□.0	250	302	150 200 250 300 350	91	4.95
6500.300.□.0	300	352	150 200 250 300 350	91	5.10
6500.350.□.0	350	402	150 200 250 300 350	91	5.30
6500.400.□.0	400	452	150 200 250 300 350	91	5.50

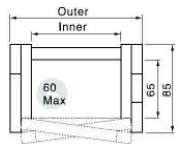

K6550 series can be open by both side

Type	Inner width (mm)	Outer width (mm)	Bending radius(mm)	Pitch (mm)	Weight (kg)
6550.100.□.0	100	152	150 200 250 300 350	91	5.50
6550.125.□.0	125	177	150 200 250 300 350	91	5.60
6550.150.□.0	150	202	150 200 250 300 350	91	5.70

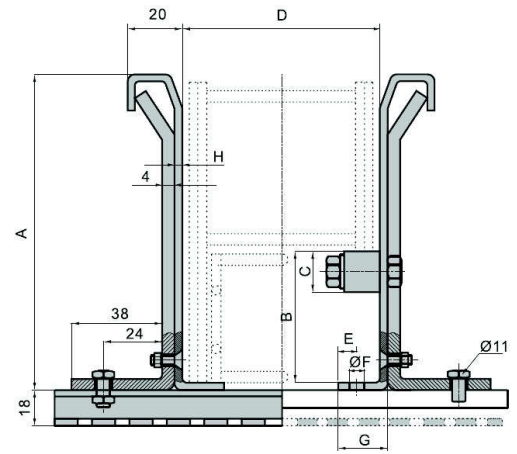
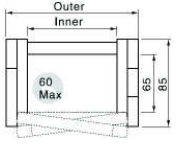

Cable tray without slide strip	1
Cable tray with slide strip	2
A	170
B	84
C	30
D	*
E	20
F	11
G	50
H	2

K8000/8050 series Installation Dimensions & Tech Data

Length calculation

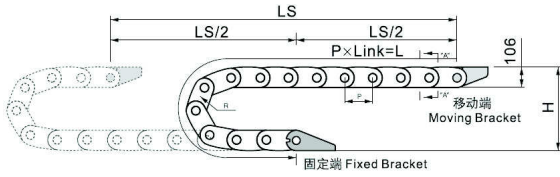

$$L = \frac{LS}{2} + \pi \times R + 364$$

L: Length
 R: bending Radius
 H: Installation Height
 P: Pitch
 364: Safety Length

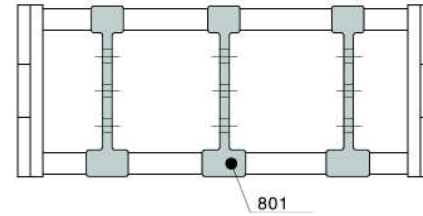
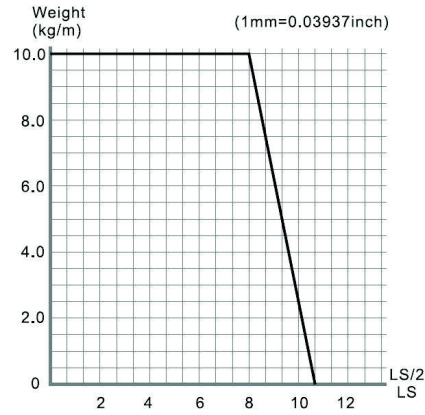

Fixed bracket

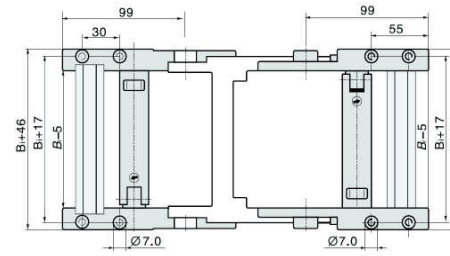

Moving bracket

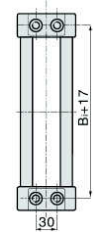

K8000 series can be open by both side

Type	Inner width (mm)	Outer width (mm)	Bending radius(mm)	Pitch (mm)	Weight (kg)
8000.100.□.0	100	155	150 200 250 300 350	91	4.50
8000.125.□.0	125	180	150 200 250 300 350	91	4.70
8000.150.□.0	150	205	150 200 250 300 350	91	4.90
8000.175.□.0	175	230	150 200 250 300 350	91	5.10
8000.200.□.0	200	255	150 200 250 300 350	91	5.30
8000.250.□.0	250	305	150 200 250 300 350	91	5.50
8000.300.□.0	300	355	150 200 250 300 350	91	5.70
8000.350.□.0	350	405	150 200 250 300 350	91	5.90
8000.400.□.0	400	455	150 200 250 300 350	91	6.10

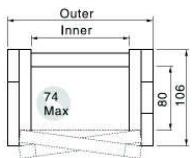

K8050 series can be open by both side

Type	Inner width (mm)	Outer width (mm)	Bending radius(mm)	Pitch (mm)	Weight (kg)
8050.100.□.0	100	155	150 200 250 300 350	91	5.70
8050.125.□.0	125	180	150 200 250 300 350	91	6.00
8050.150.□.0	150	205	150 200 250 300 350	91	6.30

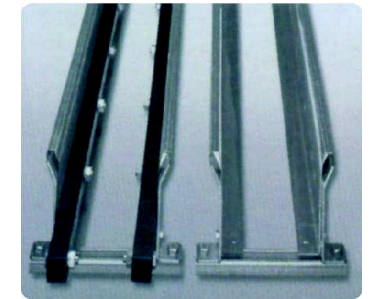
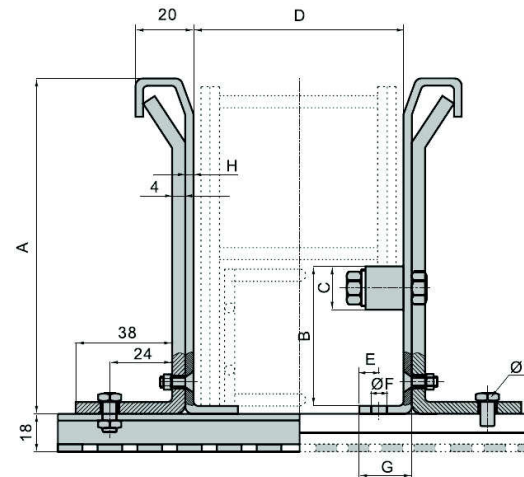
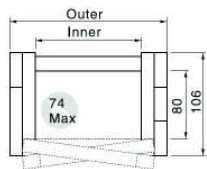

Cable tray without slide strip	1
Cable tray with slide strip	2
A	220
B	108
C	30
D	*
E	20
F	14
G	50
H	2.5